



### **Quick Summary**

---

**Land Area:** 27,405 sq. ft.

### **Property Description**

---

For Sale – Boomers, St. Lawrence Gap is a large flat corner lot perfect for an investor looking to build a boutique hotel, condominiums, or townhouses in one of Barbados' most popular tourist areas.

The lot falls under the Special Development Areas act which allows for exemptions and tax concessions for developers, making this an exceptional buy for anyone looking to build.

With an ideal location within walking distance to restaurant, bars, entertainment centers, beaches and much more, Boomers set the site for a thriving tourism-based venture. Nearby developments include Monterey Apartments Hotel, Sapphire Beach Condos, Sandals Barbados Resort and Turtle Beach Hotel all setting the tone for this tourist driven area.

The property is within walking distance of Dover Beach, St. Lawrence Gap, Maxwell Beach, and many other South Coast Amenities. There are also bus routes, rental car companies within walking distance and a 5-minute drive to both Bridgetown and Oistins.

Contact our real estate sales team today at [info@realtorslimited.com](mailto:info@realtorslimited.com) or +1-246-537-6930 for more information or to schedule a walkthrough.

### **Property Type:** **Amenities**

---

5 Minutes To Bridgetown  
Beach within 1KM  
Breezy  
Centrally Located  
Corner Lot  
Established Neighbourhood  
Flat Lot

Onsite Parking  
Private Development  
Road Parking  
Walking Distance To Ocean

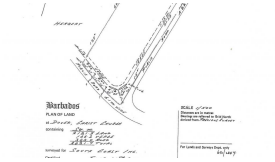

---

**Source URL:** <https://realtorluxuryestatesales.com/properties/st-lawrence-gap-boomers-lot-114-84-christ-church-barbados>